

P1 CONFIG.

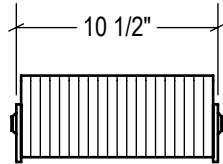

P2 CONFIG.

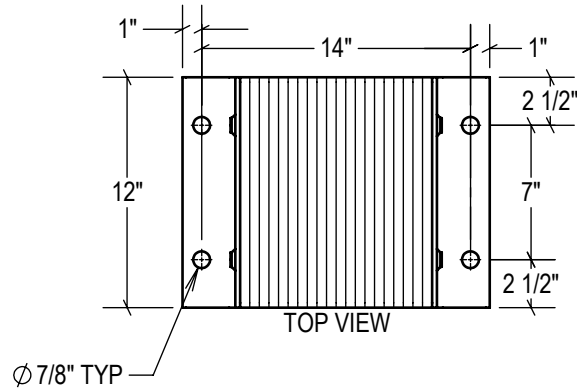

TOP VIEW

Ø 7/8" TYP

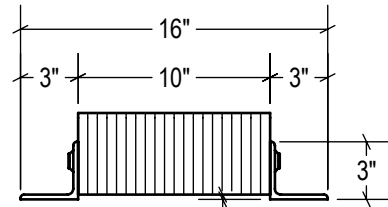

FRONT VIEW

1/4" GAP

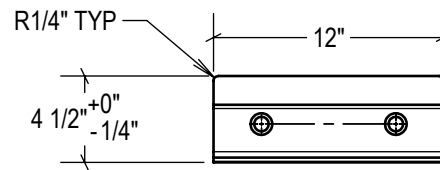

SIDE VIEW

STANDARD
model #: ECONO-LB412-14
part #: 27-1003
Bolted (2) Sides

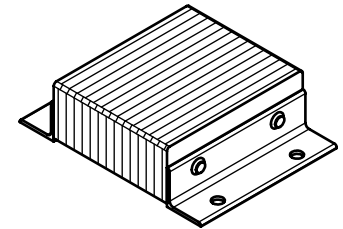

P1 CONFIG.
model #: ECONO-LB412-14/P1
part #: 27-1004
Welded (1) Side

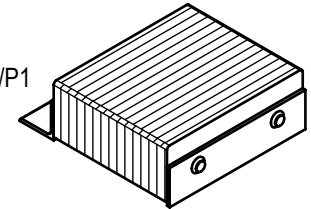

P2 CONFIG.
model #: ECONO-LB412-14/P2
part #: 27-1005
Welded (2) Sides

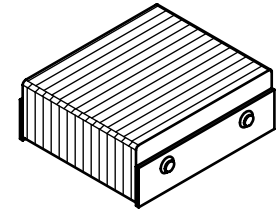

ESTIMATED GROSS SHIPPING WEIGHT = 37 LBS

SPECIFICATIONS:

FURNISH AND INSTALL LAMINATED RUBBER DOCK BUMPERS AS MANUFACTURED BY IDEAL WAREHOUSE INNOVATIONS, INC. LAMINATED PADS SHALL BE MADE FROM USED CONVEYOR BELTING CUT TO 4.125" x 12" PUNCHED AND ASSEMBLED THROUGH 3/4" RODS BETWEEN 3" x 3" x 1/4" STRUCTURAL STEEL UNDER 1,500 LBS OF PRESSURE. FINISH OF EXPOSED METAL SHALL BE PAINTED WITH WATER-BASED AND LEAD-FREE PAINT OR HOT-DIPPED GALVANIZED (OPTIONAL).

ALL DIMENSIONS ARE ± 1/4" UNLESS SPECIFIED OTHERWISE

DRAWN BY:

T.CHUNG

DATE:

2018-12-12

CHECKED BY:

DATE:

THE INFORMATION CONTAINED IN THIS DRAWING IS THE SOLE PROPERTY OF IDEAL WAREHOUSE INNOVATIONS INC. ANY REPRODUCTION IN PART OR AS A WHOLE IS PROHIBITED.



3rd Angle

SIZE:

A



IDEAL WAREHOUSE INNOVATIONS INC

DESCRIPTION:
ECONO LAMINATED RUBBER BUMPER LB412-14

SCALE:
1:10

SHEETS:
1 of 1

DRAWING NUMBER:
MKT_LB412-14E

REV:
2